

Drawn by J.O. & P.H.  
Checked by P.L.

WESTINGHOUSE, CHURCH, KERR, & Co.  
ENGINEERS  
5 & 10 BRIDGE ST., NEW YORK.

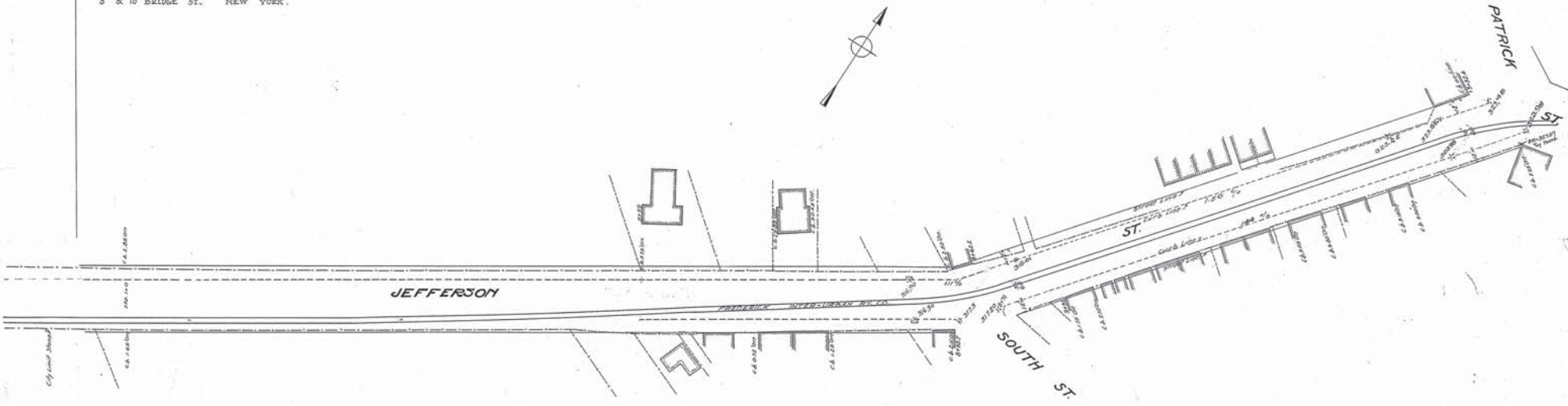

Note: The line shown in red and marked street line  
represents a line beyond which no buildings  
shall be built.  
The grade line shown on profile is an  
average grade between curbs.



Adopted by The Mayor and Aldermen of Frederick  
by ordinance passed and approved Dec. 3, 1909.

Attest:-  
*W. H. McCaffrey*  
City Registrar

The Mayor and Aldermen of Frederick  
by *Geo. Edwards Smith* Mayor.

### FREDERICK CITY. PLAN & PROFILE OF JEFFERSON STREET.

SHOWING ESTABLISHED GRADE & STREET LINE.  
Frederick Md. Jan 20, 1906.  
Sheet 1 of 1 Sheet.

N.Y. No 20468

20468

WESTINGHOUSE CHURCH, KERR & CO.

JEFFERSON STREET